

1

2

3

4

5

## REVISION TABLE

REV	ECN#	DESCRIPTION	REV BY	APPROVED	DATE
---	---	Original Drawing	SDC	MPW	6-29-15

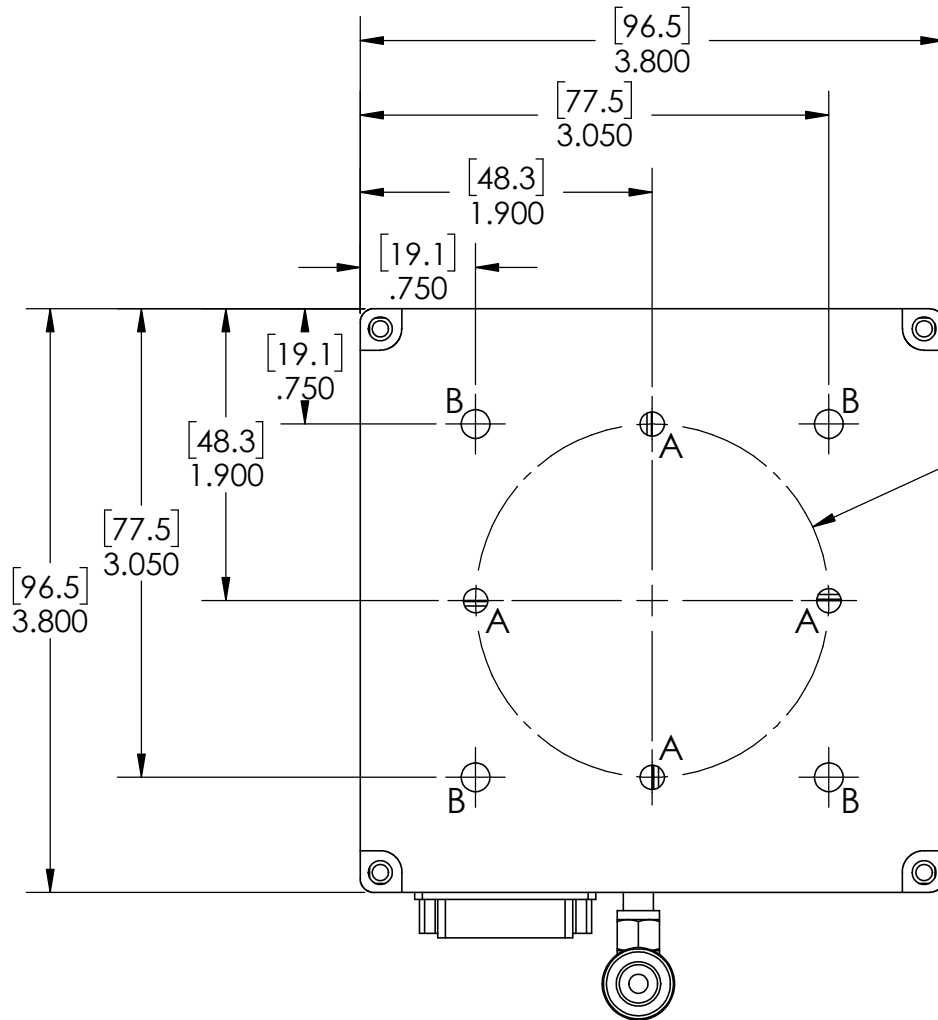

Air Inlet  
0.250" OD Air Hose

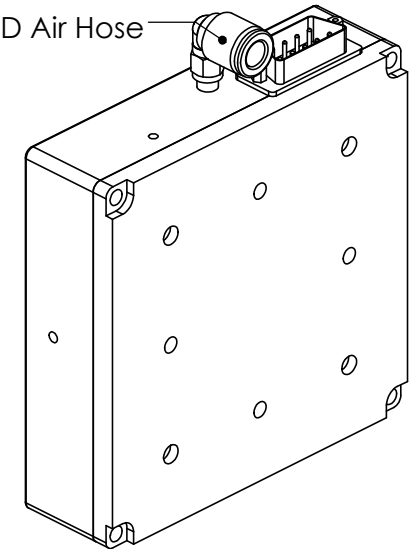

## NOTES:

- A:  $\varnothing$ .1879/.1881  
X .100 DP. MIN.  
(4 PLCS)
- B: 10-32  
X .200 DP. MIN.

Motor Power  
DB-9 Male

Pin #	Function
1	XA+
2	XA-
3	XB+
4	XB-
5	Ground
6	YA+
7	YA-
8	YB+
9	YB-

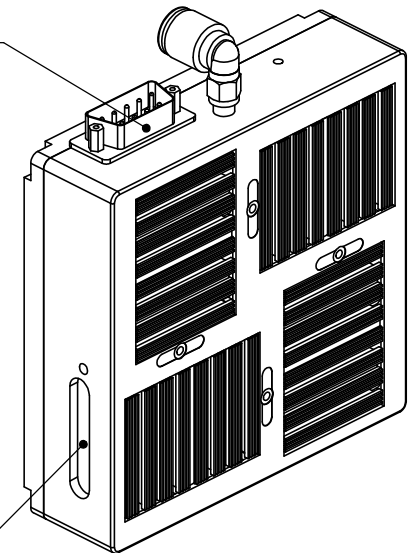

Lifting Tool Slot



**H2W Technologies, Inc.**  
Santa Clarita, CA 91350 USA  
Tel: (661) 291-1620  
[www.h2wtech.com](http://www.h2wtech.com)

These drawings and specifications are the property of H2W Technologies, Inc. They are issued in confidence and shall not be reproduced, copied, or used without written permission from H2W Technologies, Inc.

UNLESS SPECIFIED OTHERWISE:  
All dimensions are in inches  
Standard Tolerances are as follows  
.XXX  $\pm$ .005 ANGLES  $\pm$ 1°  
.XX  $\pm$ .010 FILLETS .010  
.X  $\pm$ .020 CORNERS .010  
Remove All Burrs and Sharp Edges

**FOR  
REFERENCE  
ONLY**

MATERIAL

FINISH

TITLE

**Dual Axis Linear Stepper Motor  
Model #: LMDS1302-2A1**

DWG #

**13-0004**

REV

----

DATE

6-29-15

SHEET

1 of 2

1

2

3

4

5

A

A

B

B

C

C

D

D

**Motor Specifications****LMDS1302-2A1****General**

Static Force	lbs [N]	6.0 [26.7]
Force @ 40 in/sec	lbs [N]	3.0 [13.3]
Amps/Phase	Amps	2
Continuous Power	Watts	16.8

**Electrical**

Resistance	Ohms	4.2
Inductance	mH	5.2
Electrical Time Constant	msec	0.81

**Mechanical**

Bearing Type	Air	
Nominal Air Pressure	60 psi	
Airflow	CFM [L/min]	2.0 [56]
Attractive Force	lbs [N]	90 [400]
Forcer Mass	lbs [kg]	1.1 [.50]

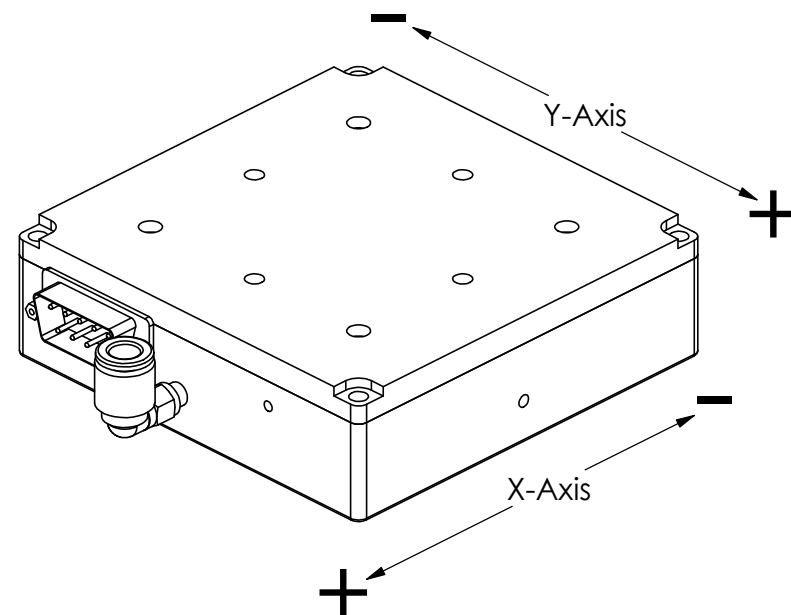
**H2W Technologies, Inc.**Santa Clarita, CA 91350 USA  
Tel: (661) 291-1620[www.h2wtech.com](http://www.h2wtech.com)

These drawings and specifications are the property of H2W Technologies, Inc. They are issued in confidence and shall not be reproduced, copied, or used without written permission from H2W Technologies, Inc.

UNLESS SPECIFIED OTHERWISE:  
All dimensions are in inches  
Standard Tolerances are as follows  
.XXX ±.005 ANGLES ±.1°  
.XX ±.010 FILLETS .010  
.X ±.020 CORNERS .010  
Remove All Burrs and Sharp Edges

**FOR  
REFERENCE  
ONLY**

MATERIAL

FINISH

TITLE

Dual Axis Linear Stepper Motor  
Model #: LMDS1302-2A1

DWG #

**13-0004**

REV

----

DATE

6-29-15

SHEET

2 of 2